

2

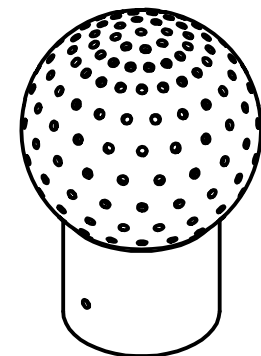

1

B



B

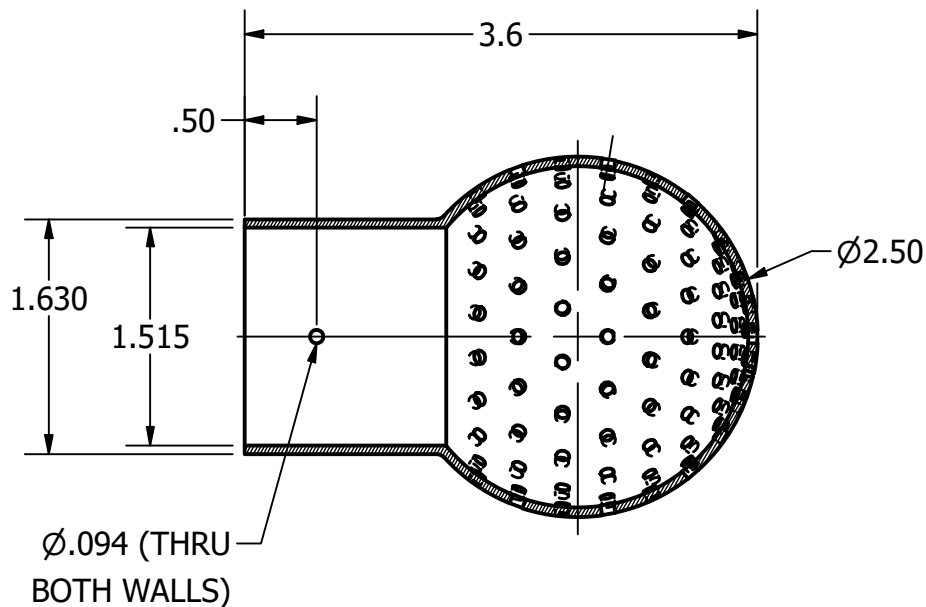

NOTES:

- 1. (165) 3/32" DIA. HOLES TOTAL, HOLES IN ROWS ARE EQUALLY SPACED.
- 2. REMOVE BURRS FROM ID/OD, MIRROR FINISH ON OD
- 3. MARKINGS TO BE ECHED, LEAVING A SMOOTH SURFACE.

A

A



CLIP REQUIRED WITH EACH SPRAY BALL

TOLERANCES	DRAWN Engineering	Steel & O'Brien Mfg. Inc.	
	3/25/2015		
DECIMALS: .XX ±.015 .XXX ±.005 .XXXX ±.0005 ANGLES: 1/2°	<ALL EDGES AND FILLETS .015 R UNLESS OTHERWISE SPECIFIED <REFER TO DOC# QS121 FOR GENERAL TOLERANCES	TITLE 1 1/2" SLIP ON x 2 1/2" SPRAY BALL WITH TYPE "A" PATTERN	
		DWG NO: SBSA-1.5X2.5	REV 2
		SCALE: 3 : 4	SHEET 1 OF 1

2



1